

STATE PROJECT	FEDERAL PROJECT	
	PROJECT	CONTRACT
8396-00-72		

STATE OF WISCONSIN
DEPARTMENT OF TRANSPORTATION
 PLAN OF PROPOSED IMPROVEMENT

TOWN OF WASCOTT, SMITH BRIDGE ROAD
 (MINONG FLOWAGE BRIDGE B-16-0135)
LOCAL STREET
DOUGLAS COUNTY

STATE PROJECT NUMBER
8396-00-72

ORDER OF SHEETS

Section No. 1	Title
Section No. 2	Typical Sections and Details (Includes Erosion Control Plans)
Section No. 3	Estimate of Quantities
Section No. 3	Miscellaneous Quantities
Section No. 4	Right of Way Plat
Section No. 5	Plan and Profile
Section No. 6	Standard Detail Drawings
Section No. 7	Sign Plates
Section No. 8	Structure Plans
Section No. 9	Computer Earthwork Data
Section No. 9	Cross Sections

TOTAL SHEETS =

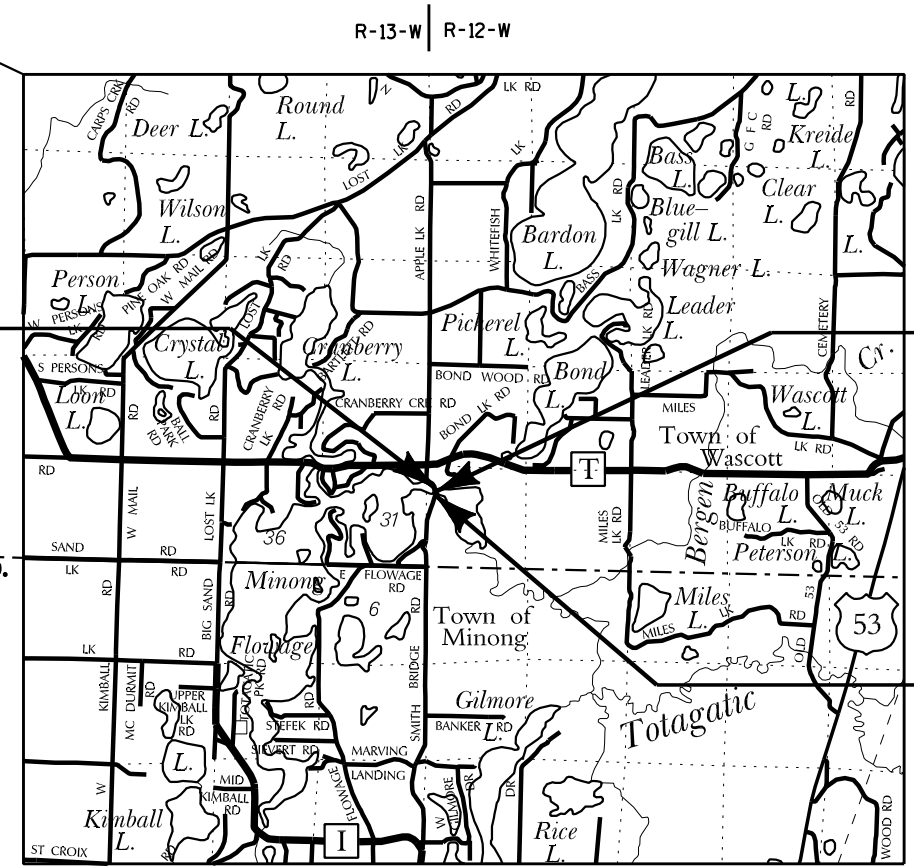
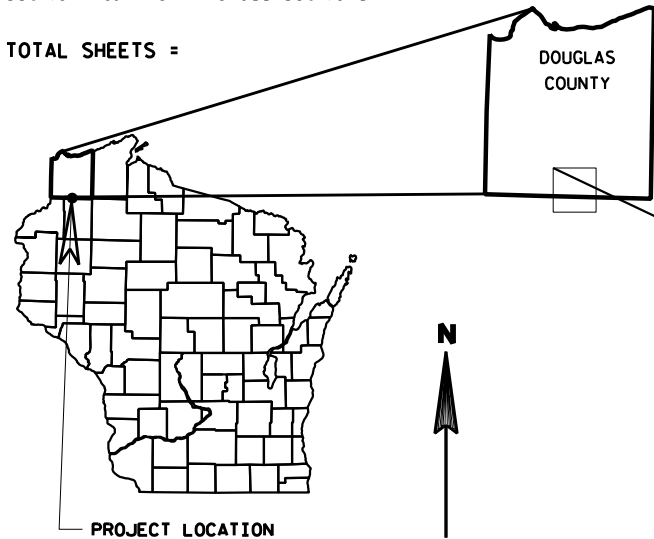

END PROJECT
STA. 13+00
 Y = 104290.10
 X = 197946.19

STRUCTURE B-16-0135

T-43-N
 T-42-N

BEGIN PROJECT

STA. 7+50
 Y = 103769.13
 X = 198039.98

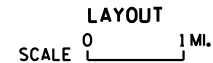

TOTAL NET LENGTH OF CENTERLINE = 0.082 MI.

COORDINATES ON THIS PLAN ARE REFERENCED TO THE WISCONSIN COUNTY COORDINATE SYSTEM (WCCS), DOUGLAS COUNTY

DESIGN DESIGNATION

A.D.T. (2015)	=	100
A.D.T. (2035)	=	130
D.H.V.	=	10
D.	=	50/50
T.	=	5.0
DESIGN SPEED	=	25 MPH
ESALS	=	N/A

CONVENTIONAL SYMBOLS

PLAN		PROFILE	
CORPORATE LIMITS		GRADE LINE	
PROPERTY LINE		ORIGINAL GROUND	
LOT LINE		MARSH OR ROCK PROFILE (To be noted as such)	
LIMITED HIGHWAY EASEMENT		SPECIAL DITCH	
EXISTING RIGHT OF WAY		GRADE ELEVATION	
PROPOSED OR NEW R/W LINE		CULVERT (Profile View)	
SLOPE INTERCEPT		UTILITIES	
REFERENCE LINE		OVERHEAD	
EXISTING CULVERT		ELECTRIC	
PROPOSED CULVERT (Box or Pipe)		FIBER OPTIC	
COMBUSTIBLE FLUIDS		GAS	
HIGH VOLTAGE		SANITARY SEWER	
MARSH AREA		STORM SEWER	
WOODED OR SHRUB AREA		TELEPHONE	
		WATER	
		UTILITY PEDESTAL	
		POWER POLE	
		TELEPHONE POLE	

ACCEPTED FOR

Town of Wascott

Date _____ Town Chairman _____

ORIGINAL PLANS PREPARED BY
AYRES ASSOCIATES 3433 Oakwood Hills Parkway
 Eau Claire, WI 54701
 www.AyresAssociates.com

Preliminary Plans
 April 21, 2014

DATE _____

STATE OF WISCONSIN
DEPARTMENT OF TRANSPORTATION

PREPARED BY

Surveyor AYRES ASSOCIATES INC

Designer AYRES ASSOCIATES INC

Management Consultant KNIGHT E/A INC.

C.O. Examiner _____

APPROVED FOR THE DEPARTMENT

DATE: _____ Management Consultant Signature _____

E

PROJECT ID: 8396-00-72
 WITH: N/A

COUNTY: DOUGLAS

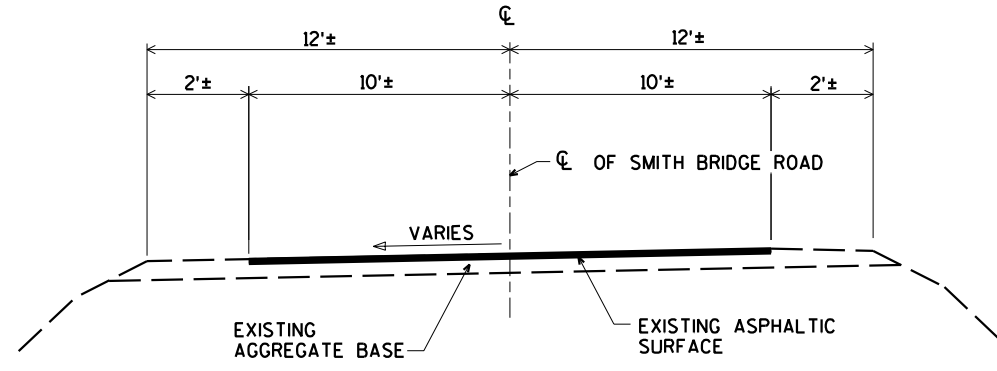

TYPICAL EXISTING SECTION
SMITH BRIDGE ROAD

GENERAL NOTES

EROSION CONTROL ITEMS TO BE PLACED AS SHOWN ON THE PLAN OR AS DIRECTED BY THE ENGINEER.

NO TREES AND/OR SHRUBS ARE TO BE REMOVED WITHOUT THE APPROVAL OF THE ENGINEER.

THE LOCATIONS OF EXISTING AND PROPOSED UTILITY INSTALLATIONS AS SHOWN ON THE PLANS ARE APPROXIMATE. THERE MAY BE OTHER UTILITY INSTALLATIONS WITHIN THE PROJECT AREA THAT ARE NOT SHOWN.

DISTURBED AREAS WITHIN THE RIGHT-OF-WAY, EXCLUSIVE OF THE ROADBED, SHALL BE FERTILIZED, SEED, AND MULCHED AS DIRECTED BY THE ENGINEER.

SEED MIXTURE NO. 20 AND SEEDING TEMPORARY SHALL BE USED IN THE PROJECT AND SHALL BE PLACED AS SHOWN IN THE PLANS AND/OR AS DIRECTED BY THE ENGINEER.

ELEVATIONS SHOWN ON THIS PLAN ARE REFERENCED TO THE NORTH AMERICAN VERTICAL DATUM (NAVD) 1988.

ASPHALTIC SURFACE SHALL BE CONSTRUCTED WITH A 2" UPPER LAYER AND A 2" LOWER LAYER. ASPHALTIC SURFACE SHALL USE 1/2" NOMINAL AGGREGATE SIZE.

UTILITIES

CENTURYLINK
P.O. BOX 518
OSCEOLA, WI 54020
ATTN: MIKE VANDENBOS
715-294-2463
mike.vandenbos@centurylink.com

EAST CENTRAL ENERGY
P.O. BOX 39
BRAHAM, MN 55006
ATTN: DAVID WALETSKI
763-691-2037
612-390-0792 (cell)
dave.waletski@ecemn.com

** DENOTES UTILITIES THAT ARE NOT DIGGERS HOTLINE MEMBERS

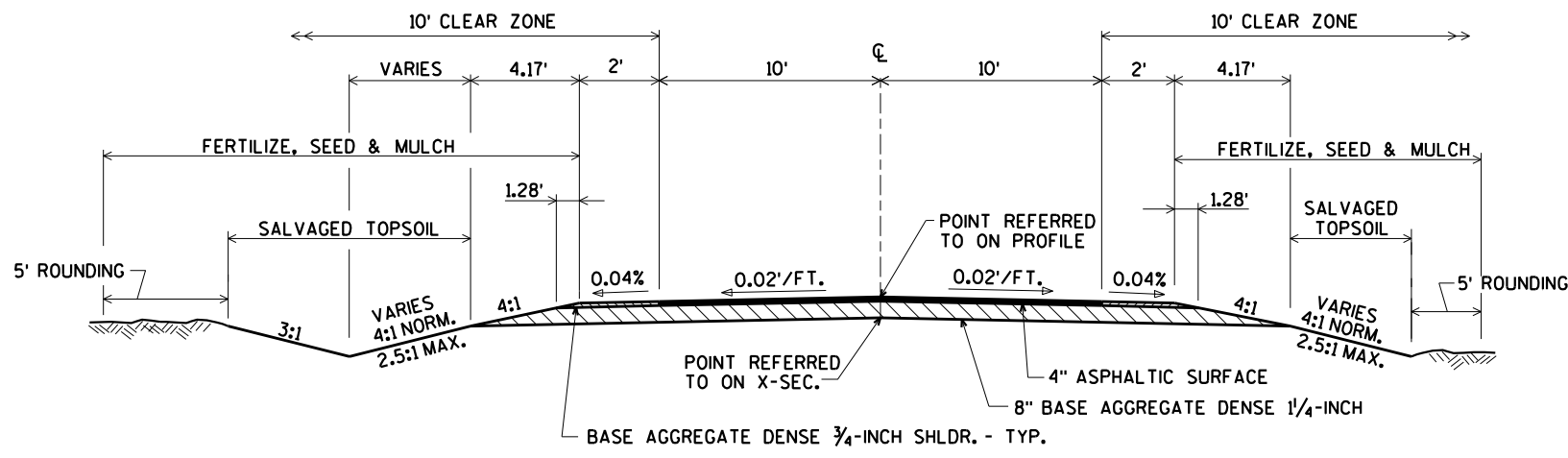

TYPICAL FINISHED SECTION
STA. 7+50 TO STA. 8+00.73

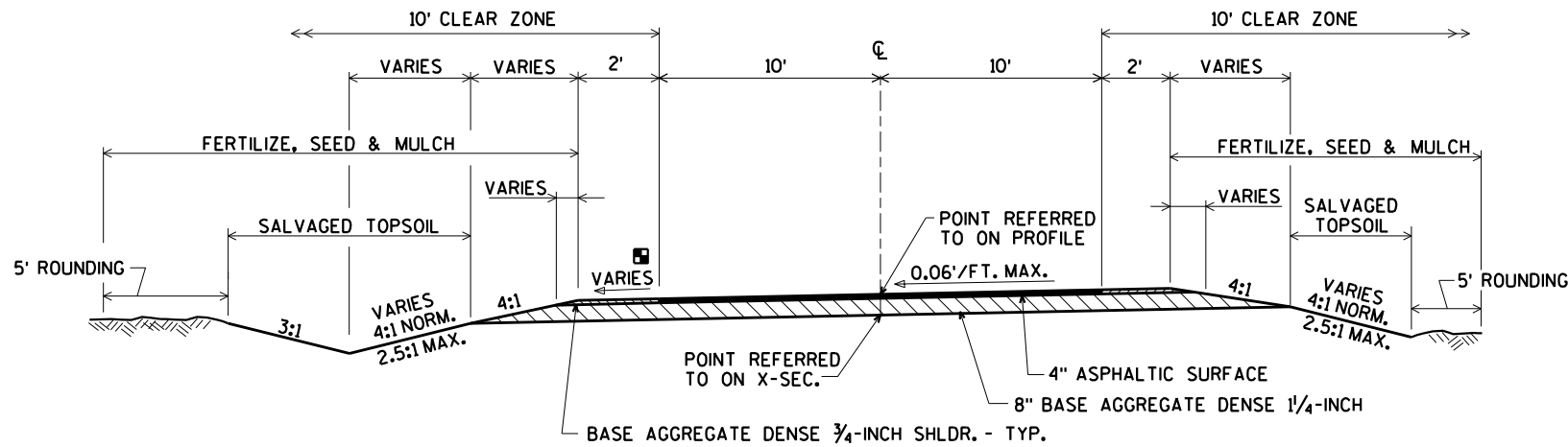

WHEN SUPERELEVATION EXCEEDS 0.04' /FT. THE SHOULDER SHALL MATCH THE SUPERELEVATION, ELSE 0.04' /FT.

TYPICAL FINISHED SECTION
STA. 11+96.09 TO STA. 13+00

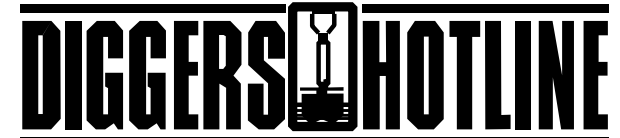

Dial 811 or (800) 242-8511
www.DiggersHotline.com

WISCONSIN DEPARTMENT OF NATURAL RESOURCES CONTACT:
AMY CRONK
810 WEST MAPLE STREET
SPOONER, WI. 54801
715-635-4229
amy.cronk@wisconsin.gov

DESIGNER
AYRES ASSOCIATES
3433 OAKWOOD HILLS PARKWAY
EAU CLAIRE, WI 54701
ATTN: DANIEL N. SYDOW
715-834-3161
sydowd@AyresAssociates.com

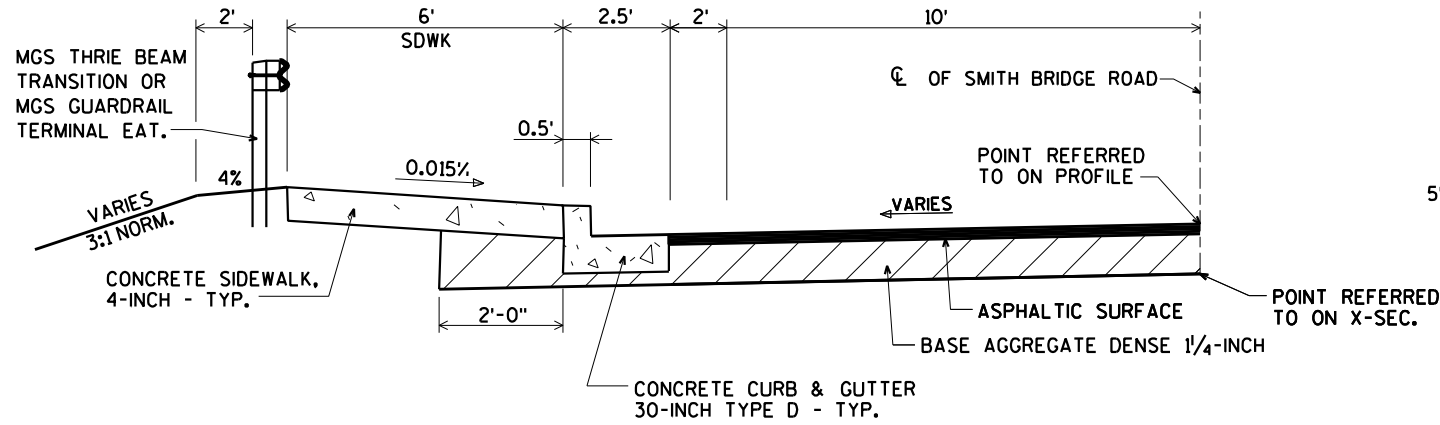

TYPICAL FINISHED HALF SECTION WITH BEAM GUARD

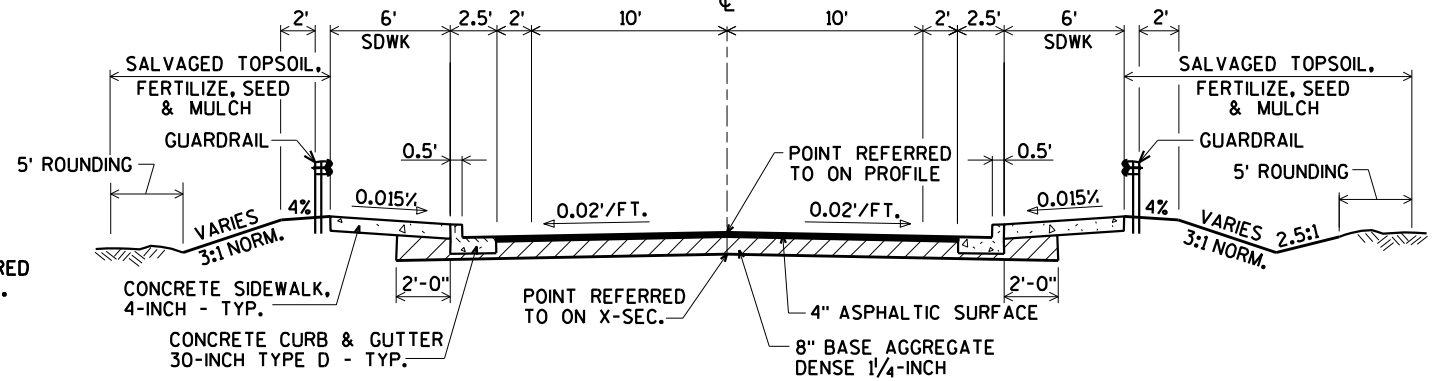

TYPICAL FINISHED SECTION

STA. 8+00.73 TO STA. 9+40.75
STA. 10+59.25 TO STA. 11+96.09

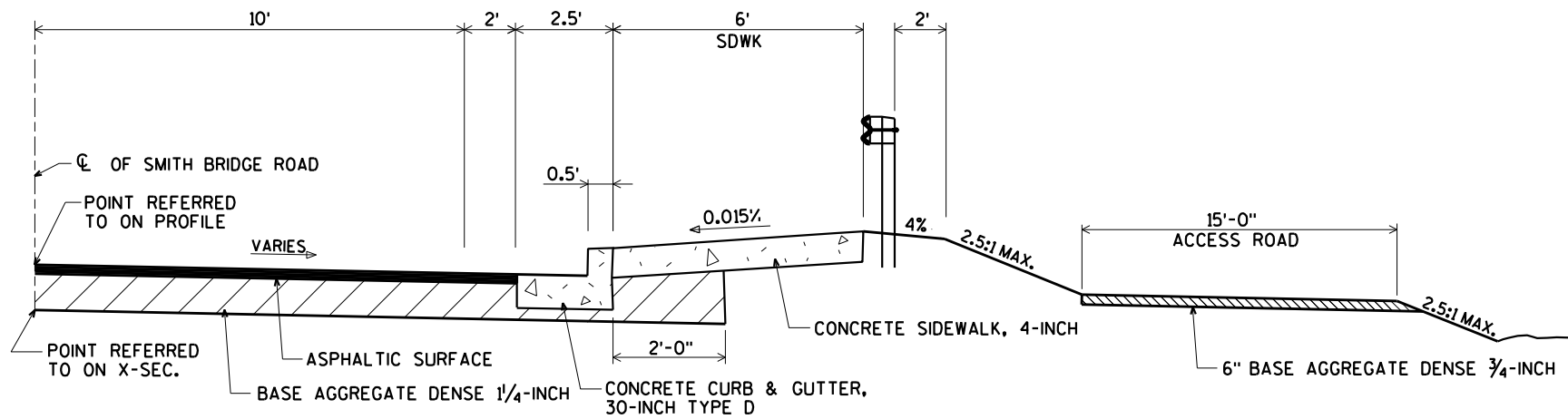

TYPICAL FINISHED HALF SECTION WITH ACCESS ROAD

STA. 10+75 TO STA. 11+75

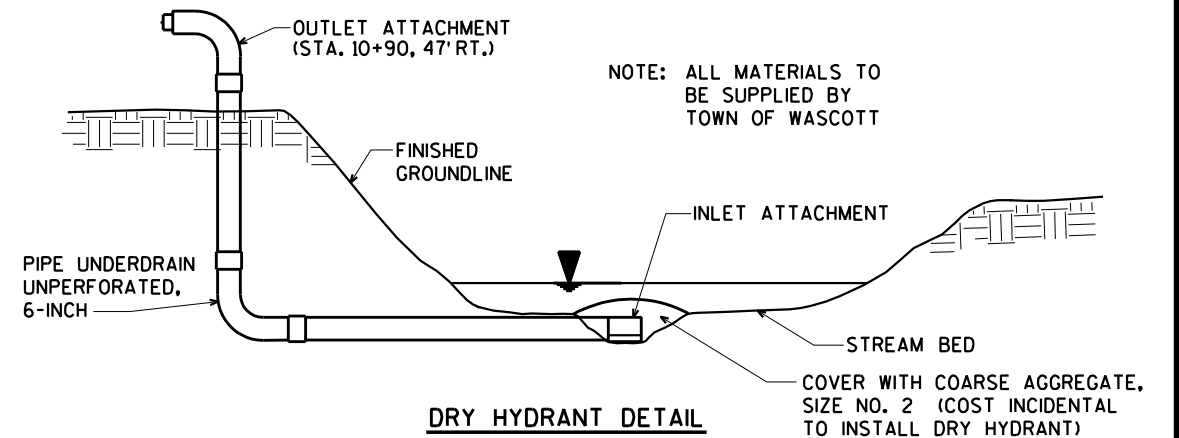

DRY HYDRANT DETAIL

R/W PROJECT NUMBER	8396-00-00	SHEET NUMBER	4.01	TOTAL SHEETS	1
FEDERAL PROJECT NUMBER					

PLAT OF RIGHT-OF-WAY REQUIRED FOR
TOWN OF WASCOTT
 MINONG FLOWAGE BRIDGE B-16-0135
 SMITH BRIDGE ROAD DOUGLAS COUNTY
 CONSTRUCTION PROJECT NUMBER

SCHEDULE OF LANDS AND INTERESTS REQUIRED

OWNER'S NAMES ARE SHOWN FOR REFERENCE PURPOSES ONLY AND ARE SUBJECT TO CHANGE PRIOR TO THE TRANSFER OF LAND INTERESTS TO THE TOWN.

PARCEL NO.	OWNERSHIP	INTEREST REQUIRED	TOTAL ACRES	R/W (SQUARE FEET)			TOTAL ACRES REMAINING
				NEW	EXISTING	TOTAL	
1	TIMOTHY STAUNER	FEE	6.85	6921	13312	20233	6.39
2	CYNTHIA A. CZERWONKA AND KIMBERLY J. TIMMERS	FEE	1.16	2595	0.00	2595	1.10
3	EDWARD S. CROZIER REVOCABLE TRUST	FEE	1.19	1246	0.00	1246	1.16
4	DOUGLAS COUNTY	FEE	17.42	9543	6714	16256	17.05
100	EAST CENTRAL ENERGY	RELEASE	----	----	----	----	----

CONVENTIONAL SYMBOLS

FOUND IRON PIPE/PIN (1" UNLESS NOTED)	PROPOSED R/W LINE	-----
R/W MONUMENT	EXISTING H.E. LINE	-----
R/W STANDARD	PROPERTY LINE	-----
SIGN	LOT & TIE LINES	-----
SECTION CORNER MONUMENT	SLOPE INTERCEPTS	-----
SECTION CORNER SYMBOL	CORPORATE LIMITS	-----
	NO ACCESS	-----
FEE (HATCH VARIES)	NO ACCESS (BY ACQUISITION)	-----
TEMPORARY LIMITED EASEMENT	NO ACCESS (BY STATUTORY AUTHORITY)	-----
PERMANENT LIMITED EASEMENT	SECTION LINE	-----
R/W BOUNDARY POINT	QUARTER LINE	-----
PARCEL NUMBER	SIXTEENTH LINE	-----
UTILITY PARCEL NUMBER	EXISTING CENTERLINE	-----
SIGN NUMBER (OFF PREMISE)	PROPOSED REFERENCE LINE	-----
BUILDING	PARALLEL OFFSET	-----

CONVENTIONAL UTILITY SYMBOLS

WATER	W	SANITARY SEWER	SAN
GAS	G	STORM SEWER	SS
TELEPHONE	T	NON COMPENSABLE	
OVERHEAD	OH	COMPENSABLE	
TRANSMISSION LINES		POWER POLE	
ELECTRIC	E	TELEPHONE POLE	
CABLE TELEVISION	TV	TELEPHONE PEDESTAL	
FIBER OPTIC	FO	ELECTRIC TOWER	

CONVENTIONAL ABBREVIATIONS

ACCESS POINT/ DRIVEWAY CONNECTION	AP	REFERENCE LINE	R/L
ACCESS RIGHTS	AR	RELEASE OF RIGHTS	ROR
ACRES	AC.	REMAINING	REM.
AND OTHERS	ET.AL.	RIGHT-OF-WAY	R/W
CENTERLINE	C/L	SECTION	SEC.
CERTIFIED SURVEY MAP	CSM	STATION	STA.
CORNER	COR.	TEMPORARY LIMITED EASEMENT	TLE
DOCUMENT	DOC.	VOLUME	V.
EASEMENT	EASE.	CURVE DATA	
HIGHWAY EASEMENT	H.E.	LONG CHORD	LCH
LAND CONTRACT	LC	H.E. LONG CHORD BEARING	LCB
MONUMENT	MON.	RADIUS	R
PAGE	P.	DEGREE OF CURVE	D
PERMANENT LIMITED EASEMENT	PLE	CENTRAL ANGLE OR DELTA	DELTA
PROPERTY LINE	PL	LENGTH OF CURVE	L
RECORDED AS	(100')	TANGENT	TAN

TOWN

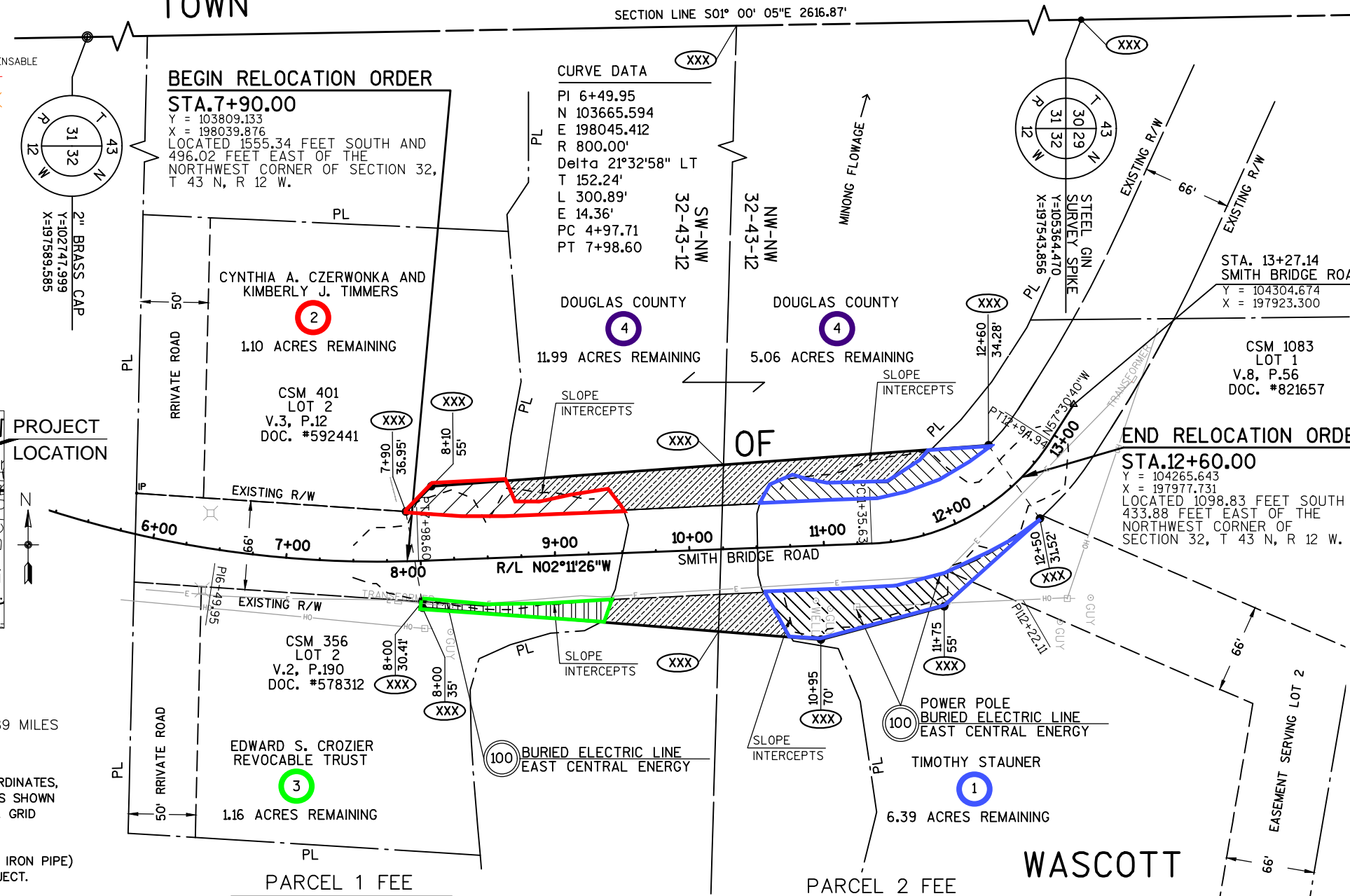

CURVE DATA

PI	12+22.11
N	104240.927
E	198023.406
R	165.00'
Delta	55°19'15" LT
T	86.48'
L	159.31'
E	21.29'
PC	11+35.63
PT	12+94.94

END RELOCATION ORDER

STA. 12+60.00

Y = 104265.643
 X = 197977.731

LOCATED 1098.83 FEET SOUTH AND 433.88 FEET EAST OF THE NORTHWEST CORNER OF SECTION 32, T 43 N, R 12 W.

BEGIN RELOCATION ORDER

STA. 7+90.00

Y = 103809.133
 X = 198039.876

LOCATED 1555.34 FEET SOUTH AND 496.02 FEET EAST OF THE NORTHWEST CORNER OF SECTION 32, T 43 N, R 12 W.

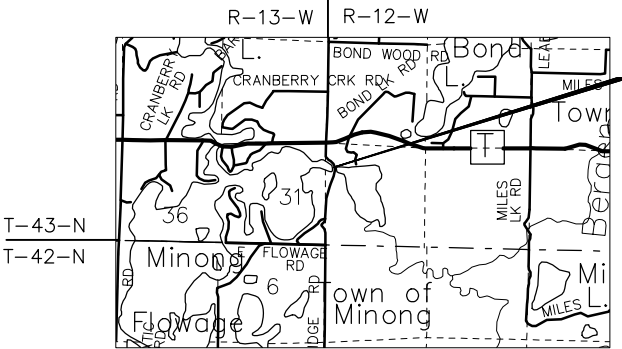

NOTES

POSITIONS SHOWN ON THIS PLAT ARE WISCONSIN COUNTY COORDINATES, DOUGLAS COUNTY, NAD83 (2011) IN U.S. SURVEY FEET. VALUES SHOWN ARE GRID COORDINATES, GRID BEARINGS, AND GRID DISTANCES. GRID DISTANCES MAY BE USED AS GROUND DISTANCES.

RIGHT-OF-WAY MONUMENTS ARE TYPE 2 (TYPICALLY 1" X 24" IRON PIPE) AND WILL BE PLACED PRIOR TO THE COMPLETION OF THE PROJECT.

RIGHT-OF-WAY BOUNDARIES ARE DEFINED WITH COURSES OF THE PERIMETER OF THE HIGHWAY LANDS REFERENCED TO THE U.S. PUBLIC LAND SURVEY SYSTEM OR OTHER "SURVEYS OF PUBLIC RECORD".

EXISTING RIGHT-OF-WAY FOR SMITH BRIDGE ROAD WAS DETERMINED FROM EXISTING PROPERTY MONUMENTATION/DEEDS, CERTIFIED SURVEY MAP 1083 RECORDED IN VOLUME 8, PAGE 56 AS DOCUMENT NUMBER 821657; CERTIFIED SURVEY MAP 401 RECORDED IN VOLUME 3, PAGE 12 AS DOCUMENT NUMBER 592441; AND CERTIFIED SURVEY MAP 356 RECORDED IN VOLUME 2, PAGE 190 AS DOCUMENT NUMBER 578312.

COURSE	BEARING	DISTANCE	PT NO	Y	X	COURSE	BEARING	DISTANCE	PT NO	Y	X
XXX-XXX	S00° 00' 00"W	0000.00'	XXX	000000.000	000000.000	XXX-XXX	S00° 00' 00"W	0000.00'	XXX	000000.000	000000.000
XXX-XXX	S00° 00' 00"W	000.00'	XXX	000000.000	000000.000	XXX-XXX	S00° 00' 00"W	000.00'	XXX	000000.000	000000.000
XXX-XXX	S00° 00' 00"W	000.00'	XXX	000000.000	000000.000	XXX-XXX	S00° 00' 00"W	000.00'	XXX	000000.000	000000.000
XXX-XXX	S00° 00' 00"W	000.00'	XXX	000000.000	000000.000	XXX-XXX	S00° 00' 00"W	000.00'	XXX	000000.000	000000.000
XXX-XXX	S00° 00' 00"W	000.00'	XXX	000000.000	000000.000	XXX-XXX	S00° 00' 00"W	000.00'	XXX	000000.000	000000.000
XXX-XXX	S00° 00' 00"W	000.00'	XXX	000000.000	000000.000	XXX-XXX	S00° 00' 00"W	000.00'	XXX	000000.000	000000.000
XXX-XXX	S00° 00' 00"W	000.00'	XXX	000000.000	000000.000	XXX-XXX	S00° 00' 00"W	000.00'	XXX	000000.000	000000.000
XXX-XXX	S00° 00' 00"W	000.00'	XXX	000000.000	000000.000	XXX-XXX	S00° 00' 00"W	000.00'	XXX	000000.000	000000.000
XXX-XXX	S00° 00' 00"W	000.00'	XXX	000000.000	000000.000	XXX-XXX	S00° 00' 00"W	000.00'	XXX	000000.000	000000.000
XXX-XXX	S00° 00' 00"W	000.00'	XXX	000000.000	000000.000	XXX-XXX	S00° 00' 00"W	000.00'	XXX	000000.000	000000.000

REVISION DATE

--	--

ACCEPTED FOR
 CLARK COUNTY

DATE _____ COUNTY COMMISSIONER _____

PLAT PREPARED BY
AYRES ASSOCIATES

THIS SURVEY IS PREPARED AT THE REQUEST OF DOUGLAS COUNTY HIGHWAY DEPARTMENT THE FIELD SURVEY WAS PERFORMED APRIL 2013 THIS SURVEY IS ACCURATE TO THE BEST OF MY KNOWLEDGE AND BELIEF

JOHN FAVORITE, R.L.S. DATE
 S-1890

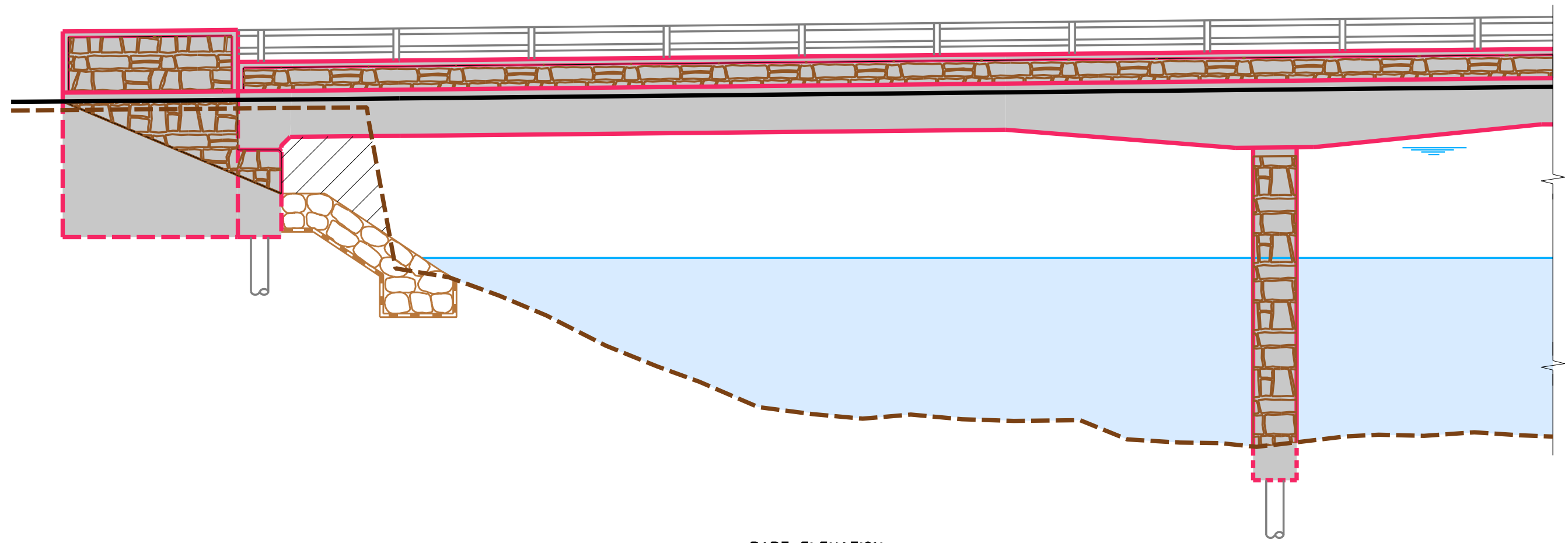

PART ELEVATION