

Town of Wascott
PO Box 159
Wascott, WI 54890
Phone – 715/466-4252 Email – wascott@centurytel.net

Quote
Replacement of Sanitary System

Site Location – 16362 S Town Hall Road, Wascott, WI

Specifications

Sanitary system components proposed:

- Septic Tank Component would consist of a Wieser Concrete W2500-MR Septic Tank fitted with a Poly-Lok PL625 Commercial Filter
- Four Dispersal cells constructed of Infiltrator Quick 4 Leaching Chambers. The minimum number based on the design flow of 995 gallons per day would be 84 chambers producing 4 dispersal cells 3 ft. x 84 ft.
- Due to the depth of the existing septic tank inlet, new piping will need to be replaced at the existing building foundation with Sch. 40 PVC solid wall pipe. The existing building sewer pipe is approximately 4 ft. 9 inches below grade and the inlet of the existing tank is 9 ft. 8 inches.
- The pipe shall run from the edge of the foundation at ¼ inch per foot to keep the pipe higher, limiting the bury depth of the new septic tank.
- Attached are copies of the Sanitary Site Plan and Cross Section of a Four Cell Inground Component Using Leaching Chambers
-

Total Amount of Quote \$ _____

Comments _____

General Information

Place Quote in a sealed envelope and mark “Replacement of Sanitary System”. Mail sealed quote to – Jeannette Atkinson, Clerk/Treasurer, Town of Wascott, PO Box 159, Wascott, WI 54890. **Quotes must be received by 12:00 Noon, Tuesday, March 5, 2019.** To obtain a quote specification, visit the town’s website at www.townofwascott.org. or contact the Clerk’s Office at 715/466-4252.

The quote must comply with all material requirements of the quote invitation and specifications. The Town reserves the right to reject any quote determined by the Town of to be nonresponsive. The Town reserves the right to reject any or all quotes.

Insurance

Prior to beginning work, the contractor shall furnish and deliver to the Town Clerk, a certificate of insurance for worker’s compensation and an umbrella certificate of liability and property insurance, and shall notify the Town Clerk immediately of any cancellation or change in insurance coverage.

Contract Award

The Town Board will make the award of the contract at a public meeting scheduled for **Tuesday, March 5, 2019 at 7:00 p.m. at the Wascott Town Hall.**

A written notice of award will be given to the successful Proposer. The Proposer is required to furnish required certificates of insurance ten (10) calendar days from the date of the notice of award.

Payment Schedule

Payment will be made within 30 days of receipt of a properly completed invoice or receipt and acceptance of the property or service. Claims for payment shall be filed with the Town Clerk.

Town of Wascott
PO Box 159
Wascott, WI 54890
Phone – 715/466-4252 Email – wascott@centurytel.net

Quote Proposal

Replacement of Sanitary Sytem

Submitted by the undersigned Proposer to the Town of Wascott, in accordance with the advertisement inviting quote proposals, **which will be received until 12:00 noon on the 5th day of March 2019**, to furnish all work for the replacement of a sanitary system.

The undersigned Proposer, if awarded the quote, agrees to complete the work as scheduled.

The undersigned Proposer, submitting this proposal, hereby declares and agrees to be bound, and to perform the work, in accordance with all terms, conditions and requirements of the within and foregoing proposal, the applicable specifications, any special provisions, and the Advertisement for Quotes, are made a part hereof as fully and completely as if attached hereto.

PROPOSAL submitted by _____
(Type or print name of Proposer)

Of (Sole Owner, Co-Partnership or Corporation) _____
If a corporation, incorporated under the laws of the State of _____

Signature of Proposer _____

Mailing Address _____

Phone _____ Email _____

Date _____

Sanitary Site Plan

For: Wascott Town Hall
Parcel in the SE1/4 - SE 1/4
Sec. 25 T43N R12W

Town of Wascott - Douglas County

2.0 Acre Parcel owned by the
Town of Wascott

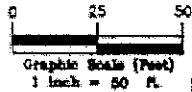

2.50 Acre Parcel

Inspect and maintain new dispersal cells once completed to prevent Pocket Gophers from establishing mounds.

Dispersal Area w/ Scrub Oak, Norway and Jack Pine Regeneration

Recommend serial distribution to insure all dispersal cells receive equal amounts of effluent prior to flowing to the next available cell.

WA-032-01318-00

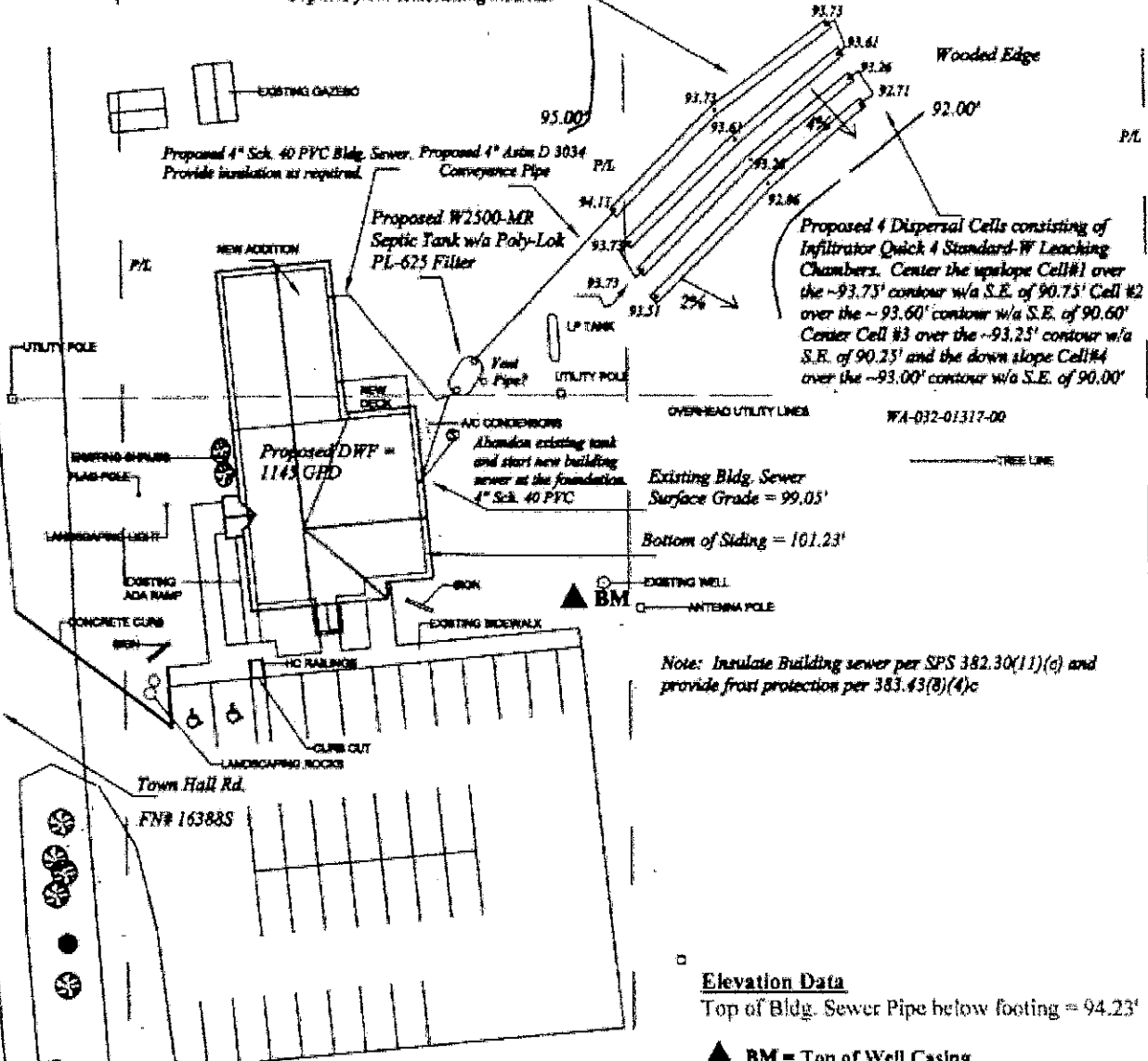

Proposed 4 Dispersal Cells consisting of Infiltrator Quick 4 Standard-W Leaching Chambers. Center the upslope Cell#1 over the ~93.73' contour w/a S.E. of 90.75' Cell #2 over the ~93.60' contour w/a S.E. of 90.60' Center Cell #3 over the ~93.25' contour w/a S.E. of 90.25' and the down slope Cell#4 over the ~93.00' contour w/a S.E. of 90.00'

Note: Insulate Building sewer per SPS 382.30(11)(e) and provide frost protection per 383.43(8)(4)c

Elevation Data

Top of Bldg. Sewer Pipe below footing = 94.23'

▲ BM = Top of Well Casing

* HRP = Same

ASSUMED ELEV. = 100.00'

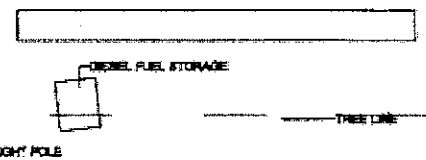

Cross Section of a Four Cell Inground Component Using Leaching Chambers

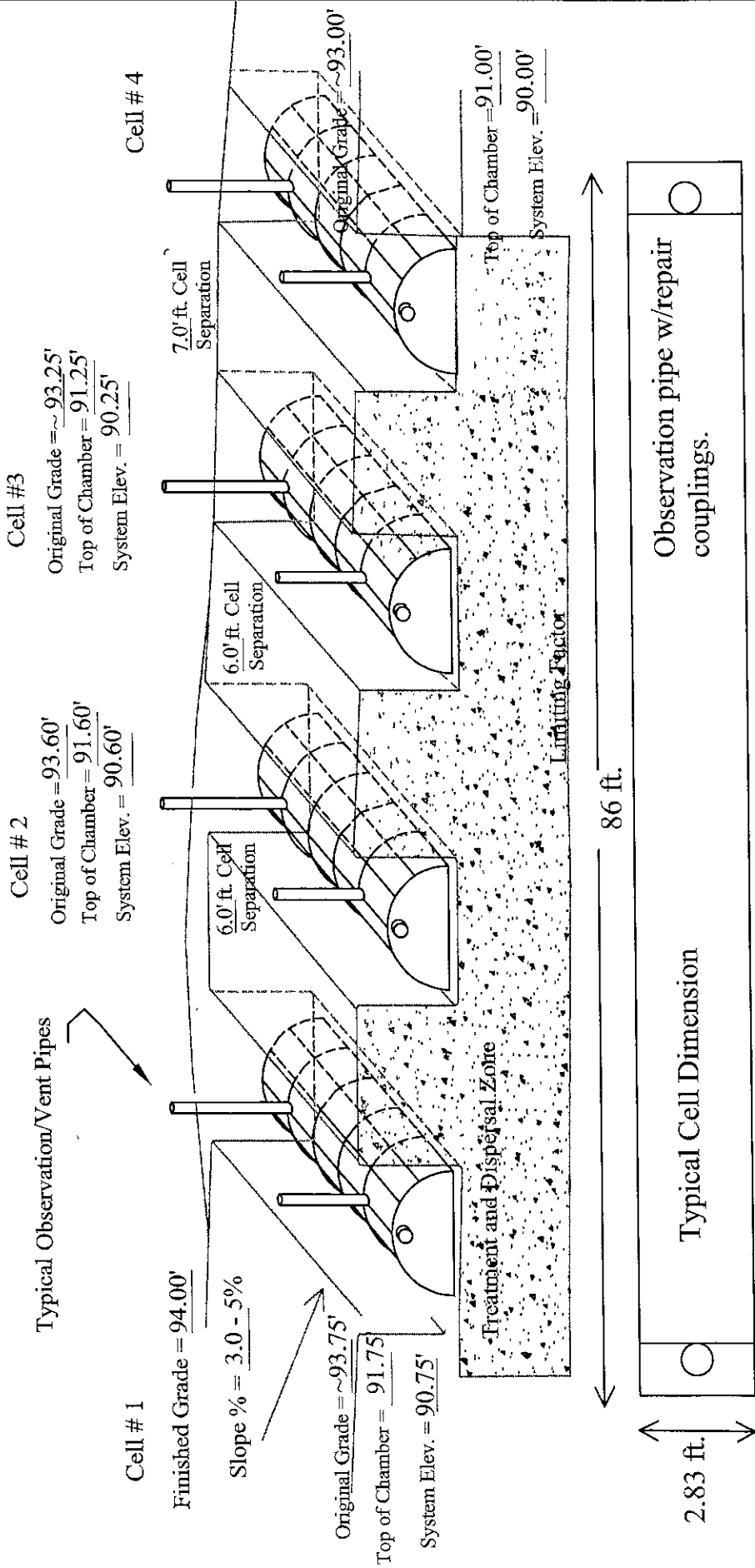

Sizing Calculations = 995 gal. DWF/.6 soil loading rate = 1658.33 sq. ft./20 Eisa rating for Infiltrator Quick 4 Standard-W leaching chambers = 83 chambers required. Proposed 84 chambers. Propose 4 cells consisting of 21 chambers per cell for a total length per cell of approx. 86 ft. Chambers are 34" x 53" x 12"

Observation/Vent pipes to be constructed and capped with approved materials for the particular use following Mfrs. printed instructions..
Proposed observation pipe w/4" Waterproof cap attached to chamber with repair couplings a minimum of 4" above infiltrative surface.